



世紀鋼鐵結構股份有限公司

Century Iron And Steel Industrial Co., Ltd



創績榮譽
責任



再生能源離岸風力計畫

- 前言、為響應政府千架海陸風機之再生能源政策方向，永傳能源股份有限公司、世紀鋼鐵結構股份有限公司與台灣國際造船股份有限公司共同發起「福海離岸風力發電計畫」，於2013年1月獲選為「風力發電離岸系統示範獎勵辦法」之最優申請人；並於同年8月份與經濟部簽署示範獎勵契約，正式成為獎勵辦法之受獎勵人。
- 壹、福海風力發電股份有限公司於今年8月份已與國際知名離岸風機供應商Siemens簽署示範機組及示範風場之風機供應合約，並將由世紀鋼構負責海底基礎鋼構製造，台船負責海事工程，以共同完成台灣第一座離岸風場的建置工作。

Outline

- **Company Introduction**
- **Plant Layout and Expansion Plan**
- **Newly Purchased Equipment**
- **Met Mast Fabrication**
- **Plan for Offshore Wind Turbine Tower Supply**

Company History

Time	Important Milestone
1987 Oct	Company established
1988 Sept	Kuan-In Plant completed, starting to fabricate all kinds of profile steel.
1998 Apr	Signed steel structure contract with Acer Display Technology, the first LCD plant in Taiwan.
2003 Oct	One of the largest steel structure engineering in Taiwan: "Nangang station CL305"
2007 May	Jinhu new plant office: began construction
2008 Mar	Mar12th: listed on stock exchange
2013 Aug	Sign the contract with BoE together with TGC and CSBC to set up the Fuhai Offshore Wind Farm
2014 Apr	Secure the Taipei Harbor lands for expansion
2014 Aug	Offshore met mast fabrication completion



Annual Sales and Contract Values

25,000
20,000
15,000
10,000
5,000
0
Million
NTD

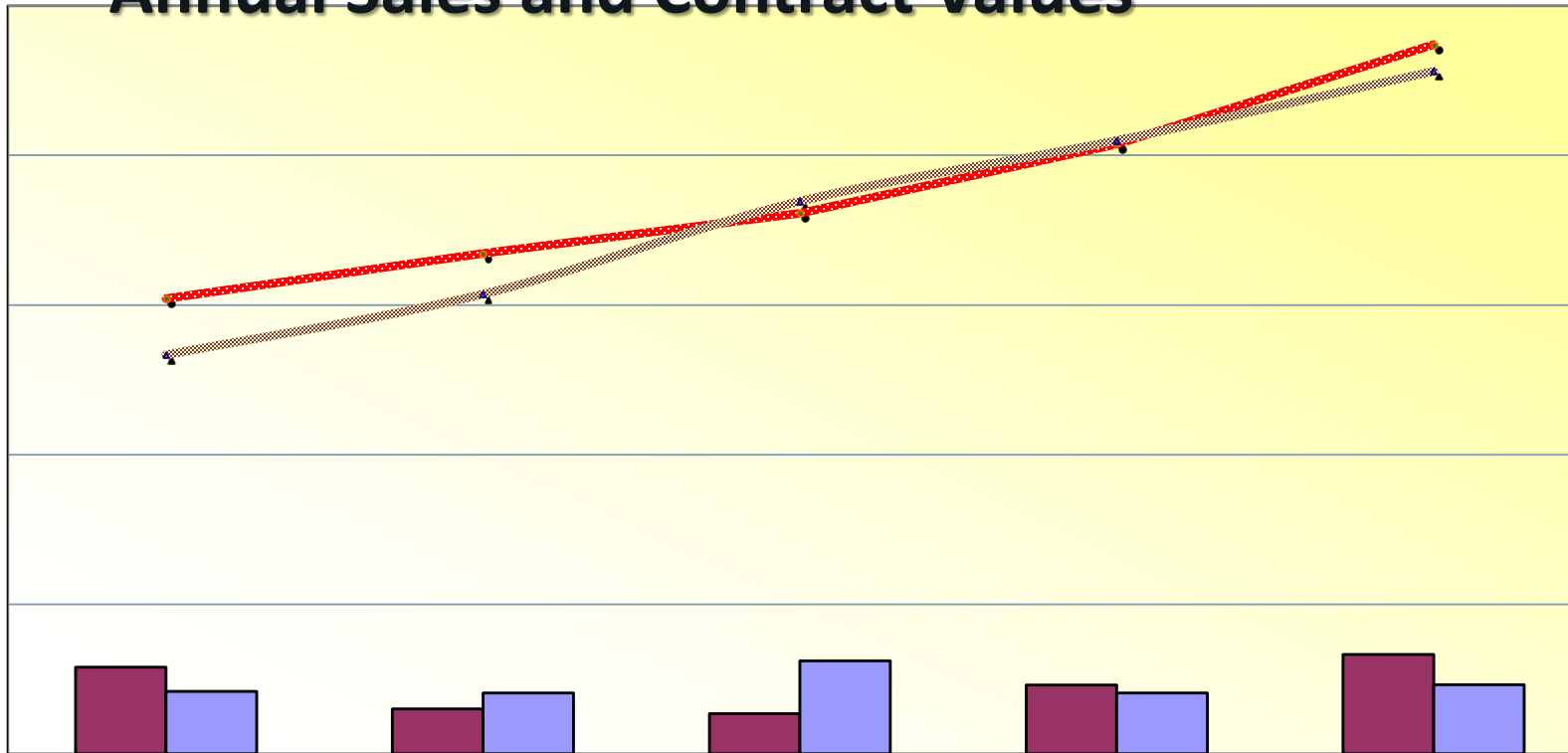

	2007	2008	2009	2010	2011
Contract Values	2,892	1,507	1,346	2,305	3,324
Sales	2,086	2,034	3,105	2,035	2,312
Contract Values(Acc)	15,215	16,722	18,068	20,373	23,697
Sales (Acc)	13,325	15,359	18,464	20,499	22,811

Revenue by Sectors 2008~2010

2008

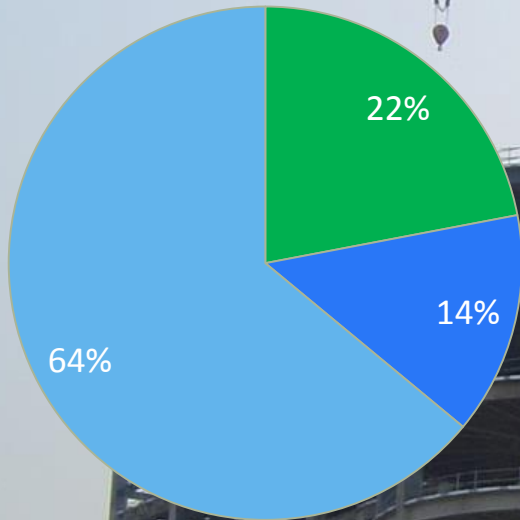

2009

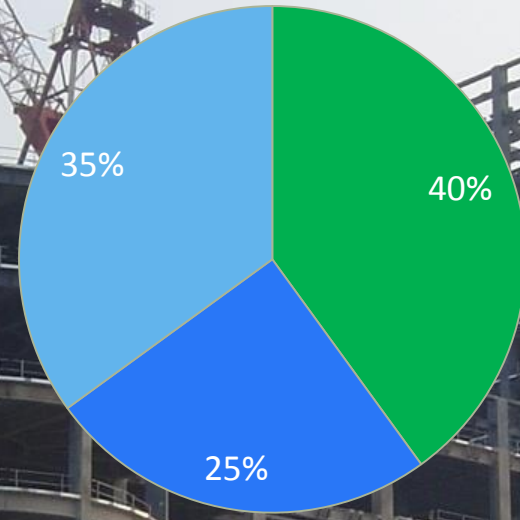

2010

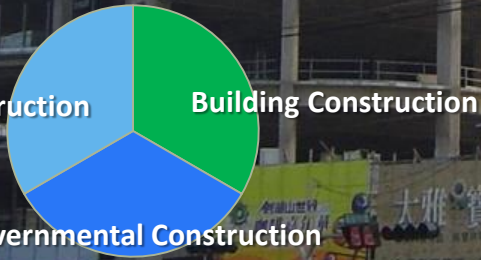
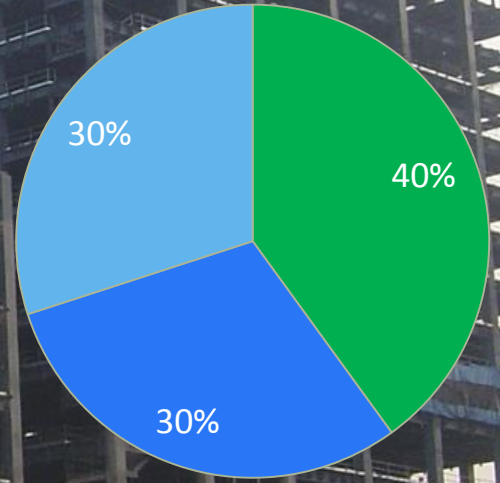

2005 10 18

1,000 Ton-Above Project Track Records (1994~2011)

Steel Amount Used (tons)

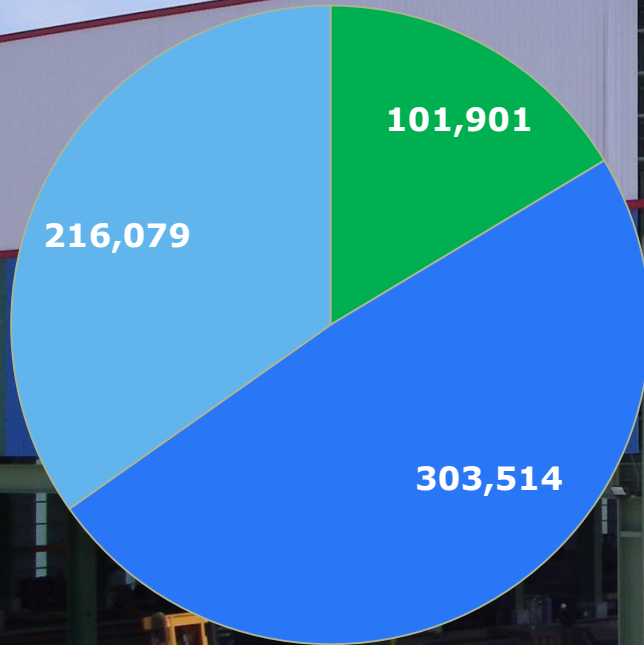

Number of Project

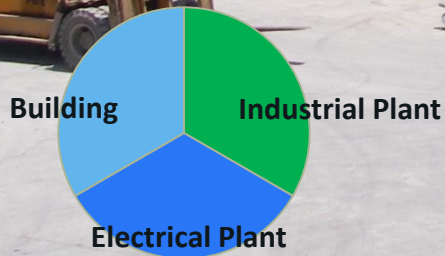
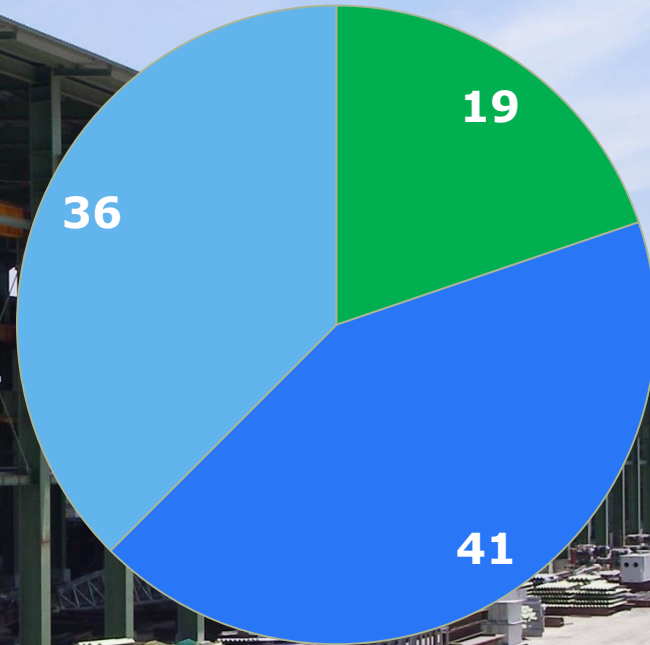



Grant Scheme Contract Signing Ceremony with MoEA on 2013/8/19



Syndication Loan Contract Signing Ceremony on 2014/7/3

Operation Status

Plants	Taoyuan Plant II	10,000 m ²	Steel plate cutting, beam and column connection
	Taoyuan Plant I	4,500 m ²	Girder, beam, sandblast and paint
	Taoyuan Storage Area	45,000 m ²	Materials and products storage
	Yunlin Plant	40,000 m ²	Manufacture steel bridge and other steel products
	Taoyuan Plant III ~ V Extension	>120,000 m ²	Manufacture steel column and steel bridge
Employee numbers	Full-time	250 people	Include foreign workers
	Part-time	70 people	Adjustable
	In-house contractors	200 people	Fabrication in plant
Annual Production	Approx. 100,000 tonnes		

Plant Layout and Future Development Plan

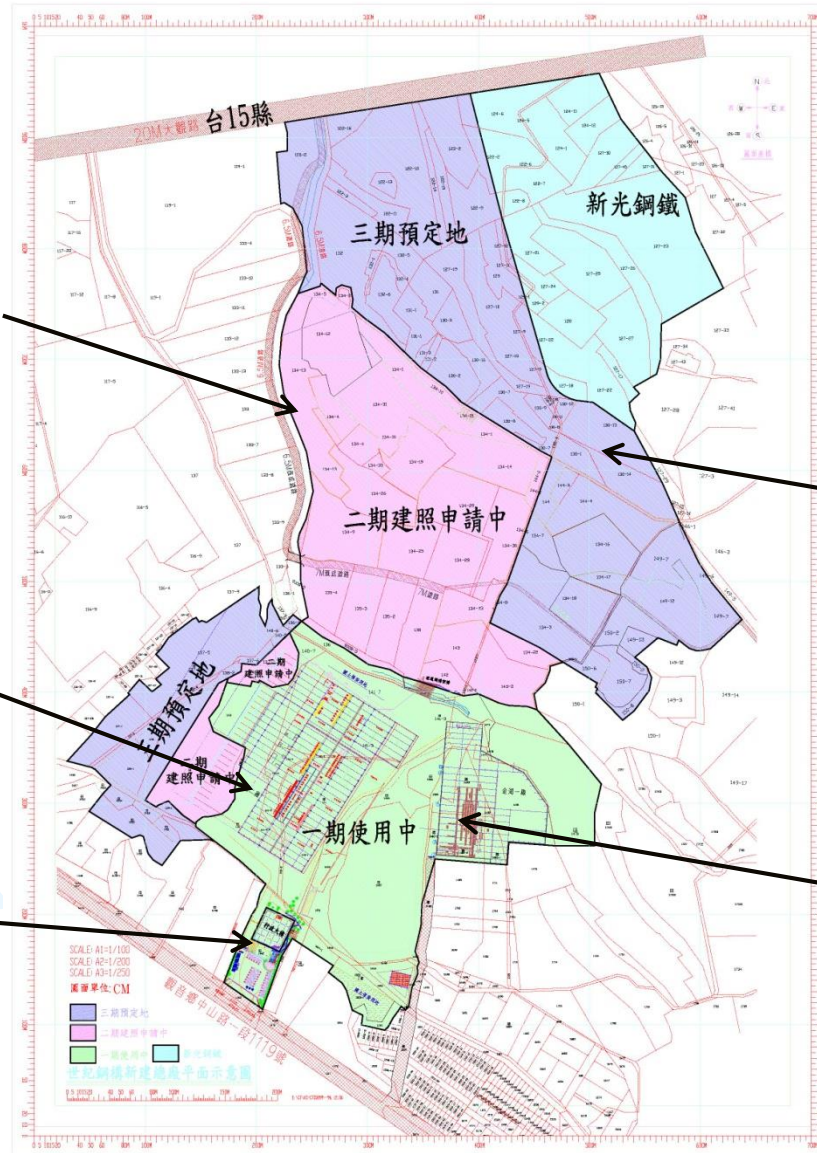

Phase Two Development Plan
(50000 m²)

Phase Three Development Plan
(75000 m²)

Jin Hu Second Plant
(approx. 22,643 m²)

Jin Hu First Plant
(approx. 25,000 m²)

Administration
Building

Note 1: to be converted to industrial used land by 2012

Phase Two Development Plan

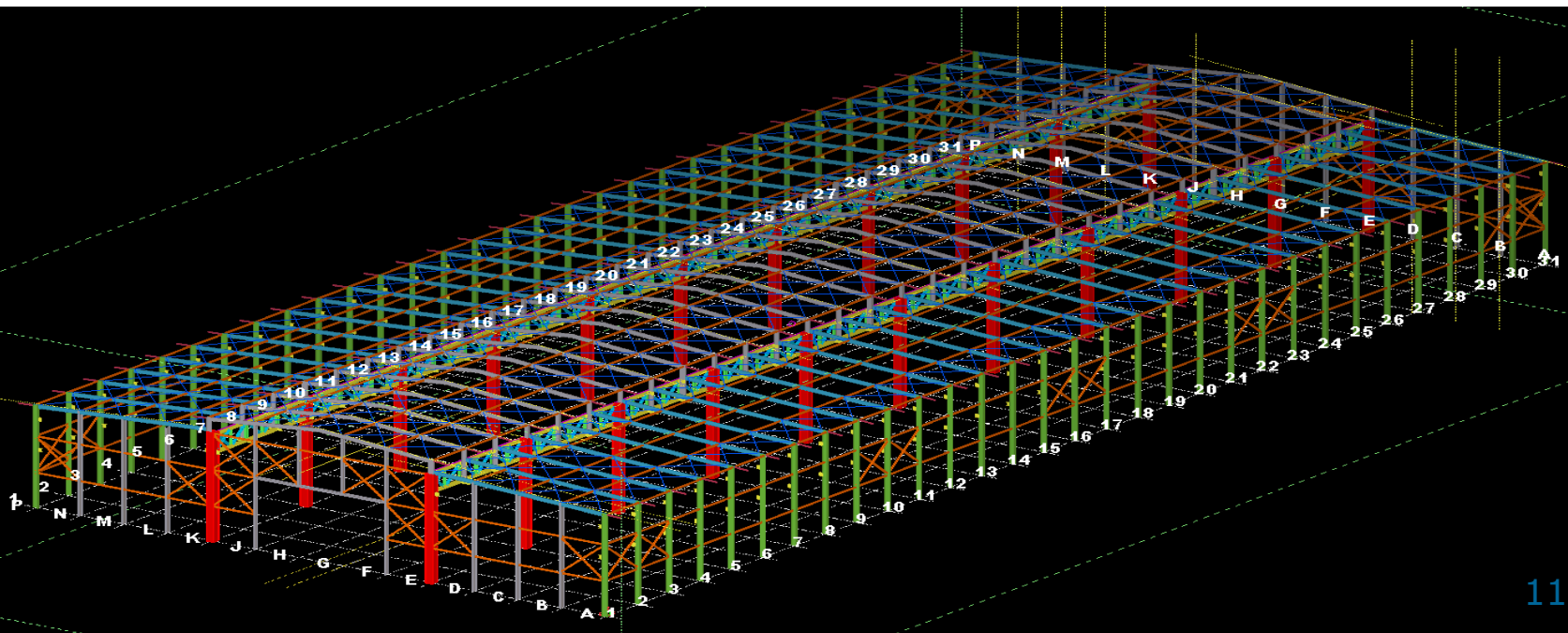
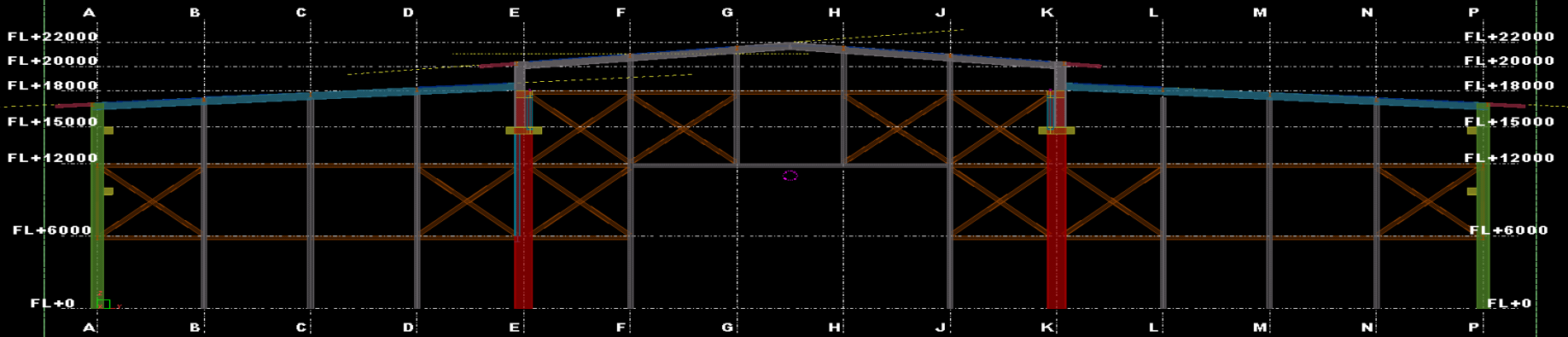



臺灣港務股份有限公司
基隆港務分公司臺北港營運處

Taiwan International Ports Corporation, Ltd.
Taipei Port Branch Office, Port of Keelung

地址：新北市八里區訊塘里商港路123號

Address：No.123, Shang Gang Rd., Shiuntang Village, Bali
District New Taipei City, Taiwan

TEL:886-2-26196000 886-2-26196038 FAX：886-2-26196017

[http：//www.tpport.gov.tw](http://www.tpport.gov.tw)

臺北港 PORT OF TAIPEI



Taipei Harbor Layout

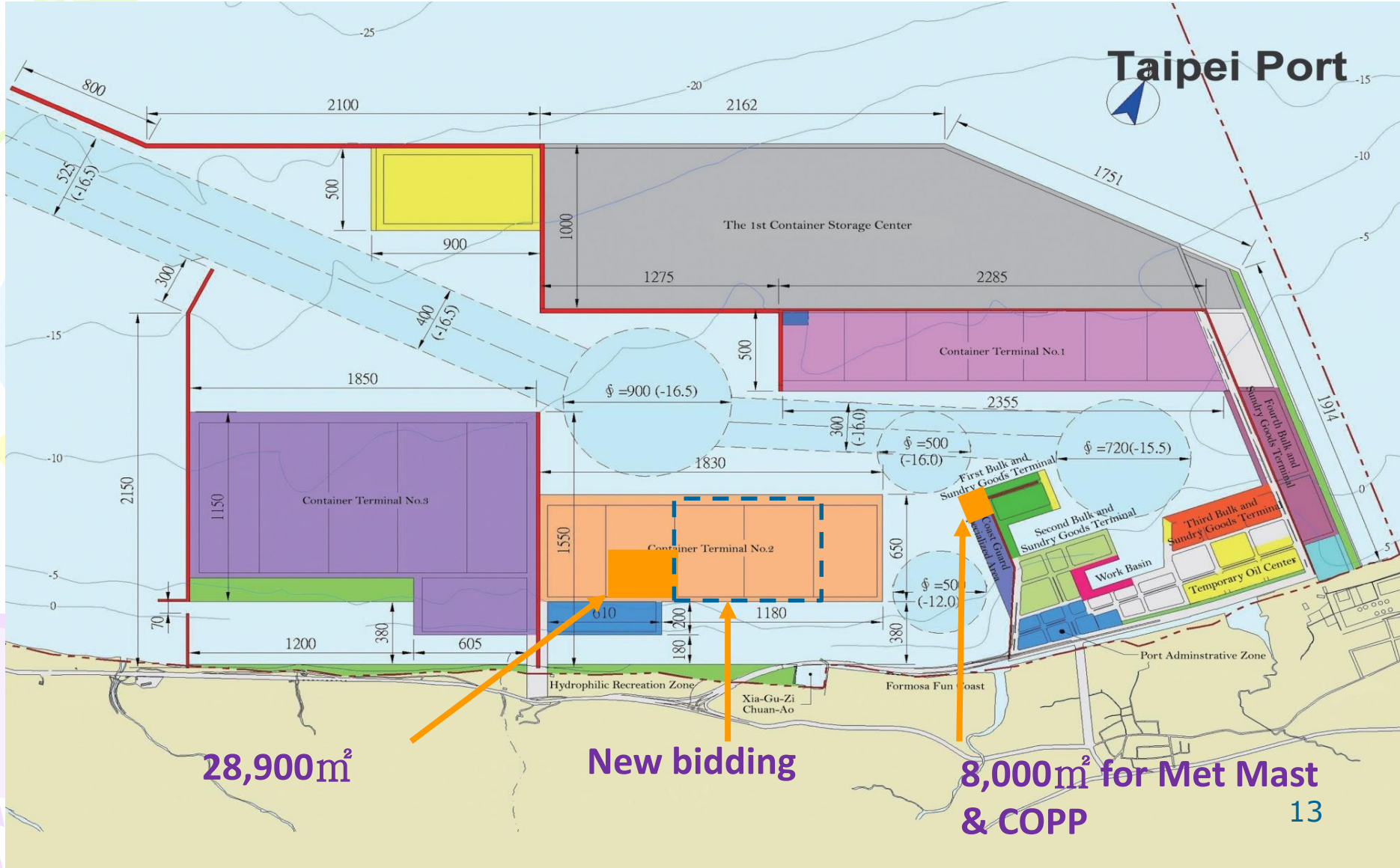

Inland Transportation Route (Century to Taipei Harbor)

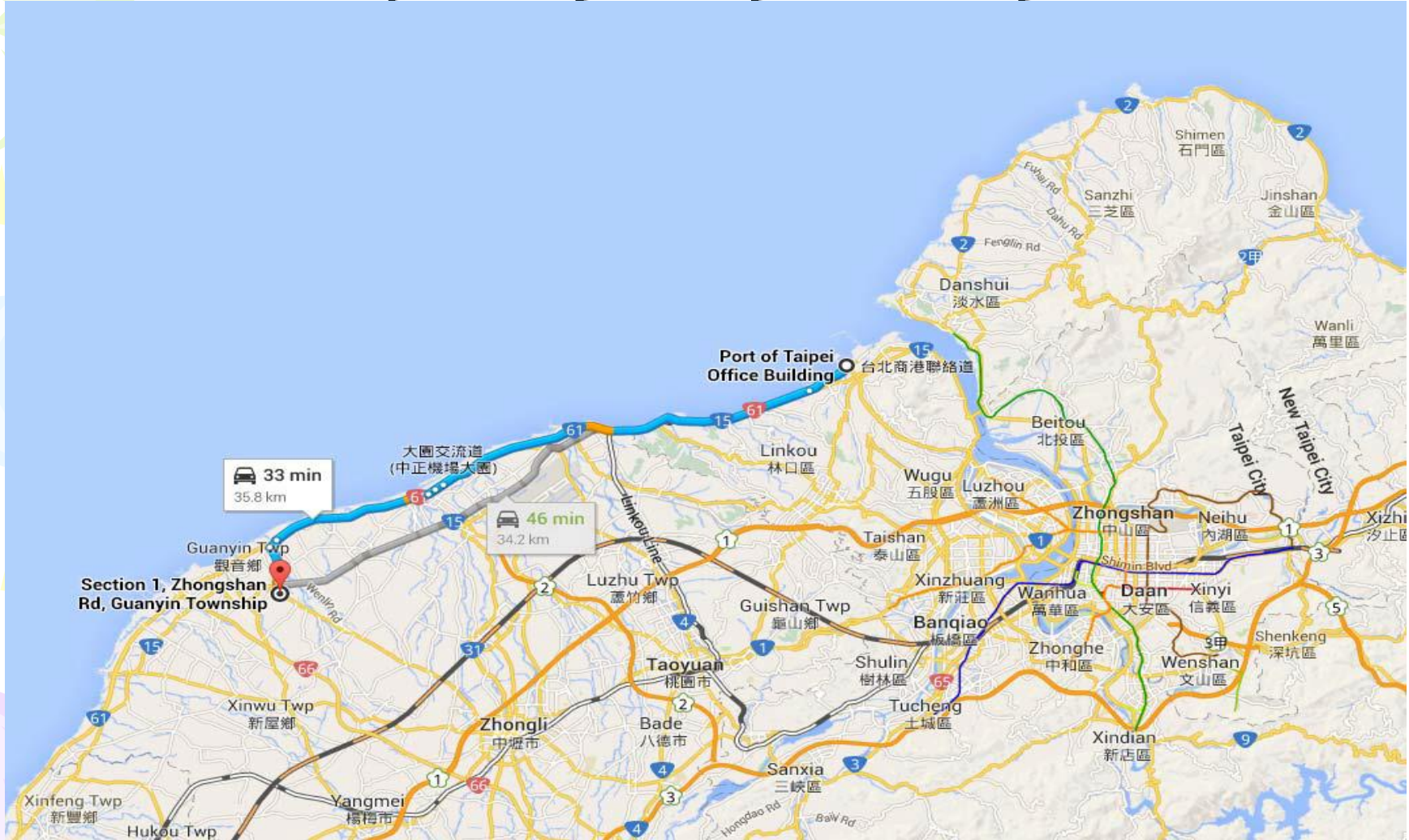

Newly Purchased Equipment

Automatic welding - Column & Booms and seamers



Newly Purchased Equipment

120/200T Rotators for welding supports



Newly Purchased Equipment

FACCIN-Plate Roller (150mm)



STANDARD CONFIGURATION:

- Variable geometry with three moveable rolls;
- Linear Slides for roll movement (RGS);
- Induction hardened and surface polished rolls;
- Electronic Balancing System (EPS);
- Special Breaking System for optimal prebending;
- Cone bending attachment;
- Control console moveable on wheels;
- Centralized Lube system (pump);
- Siemens Numerical Control Unit;
- Safety Guard cable around the machine;
- Machine CE certified for its safety;

UPON REQUEST:

- Automated loading and unloading systems;
- Motorized roller feed tables;
- Automatic ejectors;
- Side and Top plate supports;
- Machines designed for rolling hot plates;
- Lower Budget Swing Arms solution;
- Integrated welding systems;
- Special colours;

Ask for specific brochures or download them from our web site www.faccin.com

the bending roll specialist



FACCIN srl | 19

Met Mast Design

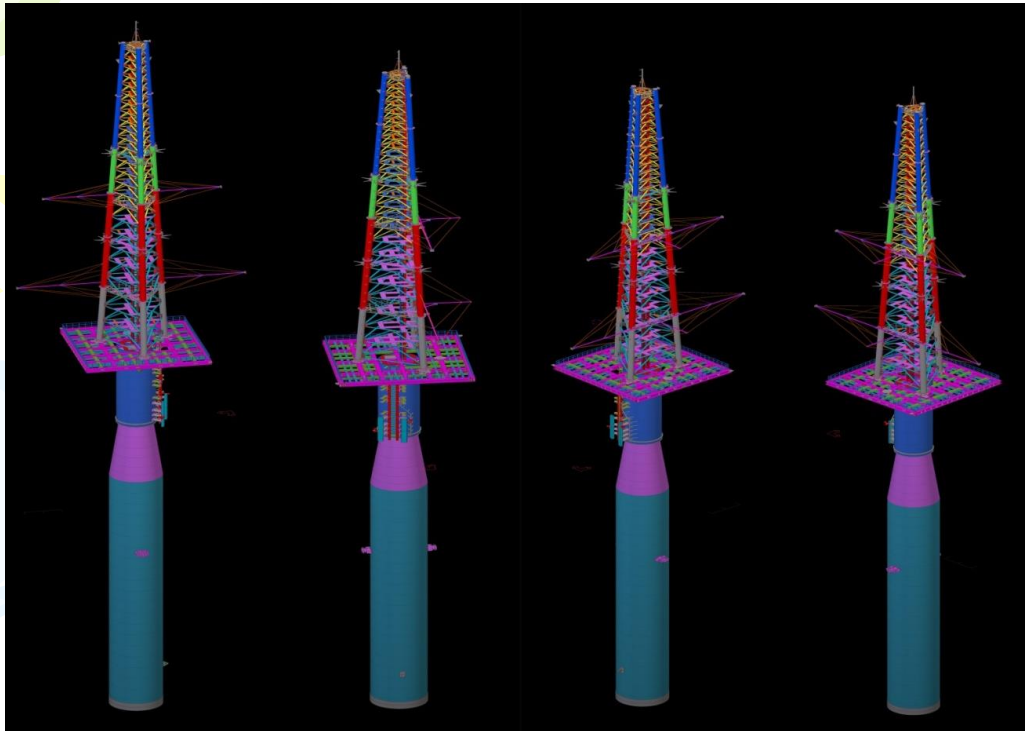

Tower	68m Lattice Structure
Pile	Length:68 m
	Diameter:4.2m
	Thickness:50mm
	Weight: 340 T



Met Mast Fabrication (Pile and Platform)



Met Mast Fabrication (Pile and Tower)



Pile Transportation (From Century to Taipei Harbor)



Pile Assembly at Taipei Harbor



2016/9/6

Platform and Transition Piece Assembly at Taipei Harbor



Platform and Transition Piece Assembly at Taipei Harbor

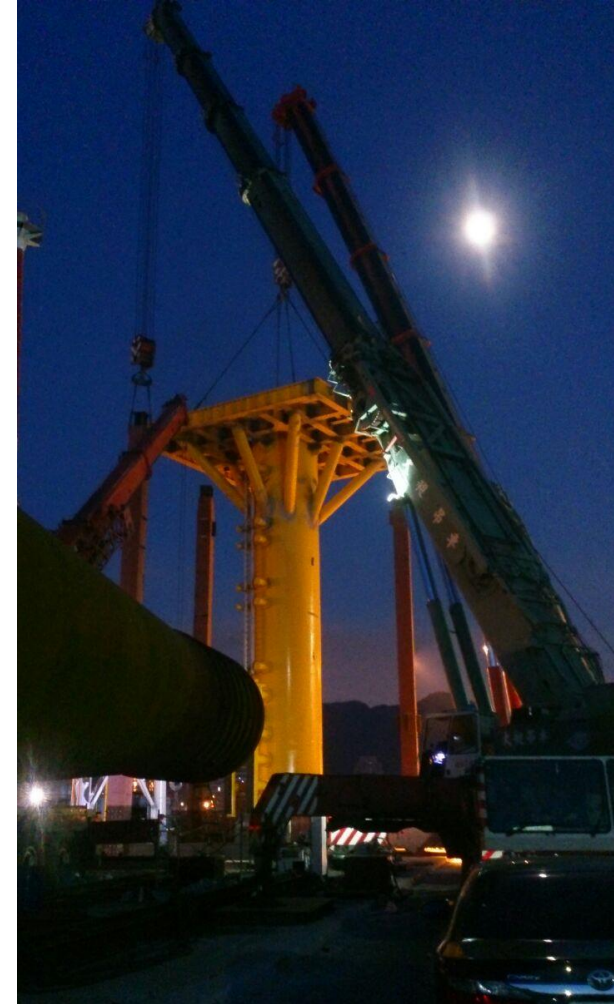
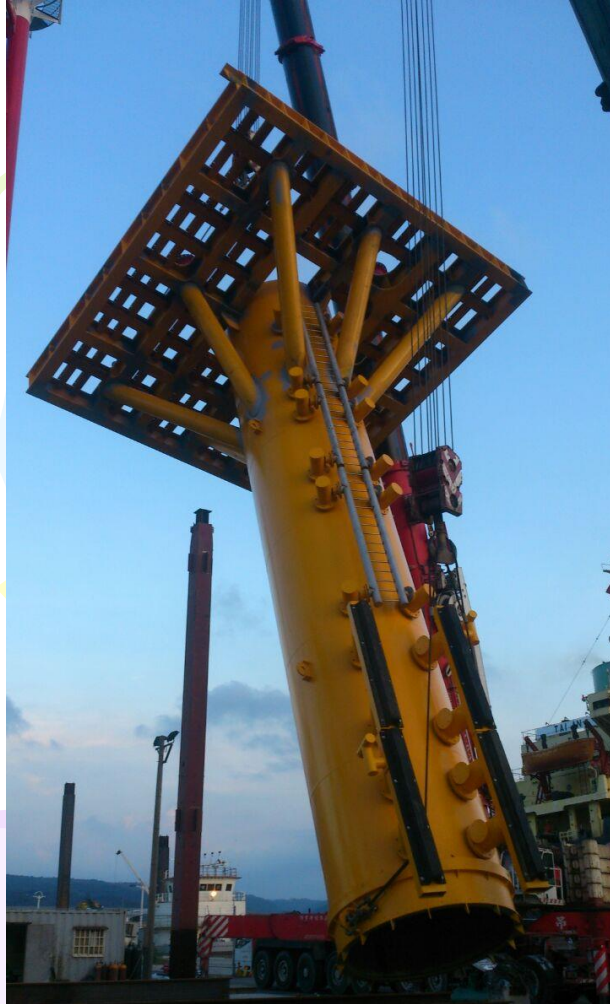

Met Mast Assembly at Taipei Harbor



Next Step – WTG Tower Fabrication

- Welding Fabrication Capacity;
- QA & EHSE system;
- Enclosed Warehouse for Painting and Sand Ballasting;
- Feasible Production Line;
- Transportation Solution.



Planned Timeline for WTG Tower Fabrication

2014

Met Mast Fabrication Experience

Work with TGC and GWP to Bring in Government Supports (MIRDC and ICP)

Qualified Personnel Training

WPQS, PQR & WPS Validation

Enhance QA System and Documentation

Enhance EHSE System and Documentation

New Factory and Production Line Planning

2015

New Equipment Purchase

New Factories Set Up (including Painting and Sand Ballasting Warehouse)

Fulfill SCM Qualification Requirement

2016

Supply Offshore Wind Turbine Towers to SCM



Thank You



2016/9/6